

July 2011

Public transport

The Hills M2 Motorway forms part of the strategic bus corridor network for Sydney and is an important public transport corridor with up to 27,000 bus commuters using the motorway each day.

The motorway is undergoing a major period of construction that may result in traffic delays to motorway users, including public transport passengers. The project team is maintaining regular discussions with bus operators, the RTA and the motorway operator regarding the planning and implementation of traffic management on the motorway.

We are committed to ensuring the impacts of construction are minimised for all commuters during construction. The upgrade is expected to be completed in early 2013.

Questions and answers

Q: Will bus services on the motorway operate during construction?

A: Yes, bus services will continue to use the motorway throughout the construction phase. However, there will be some changes to bus lanes. The current bus lanes arrangements during construction are:

- Westbound from Barclay Road bus stop to Windsor Road
 - Eastbound from Barclay Road bus stop to the Kent Street footbridge, Epping
- Outside of these areas, buses on the motorway will use the general traffic lanes during construction.

Q: What bus stops are affected by the upgrade work?

A: All the bus stops on the motorway will remain open during construction.

The bus stop located on the northbound carriageway of Windsor Road adjacent to Junction Road, Northmead was closed in June 2011 so that construction of the new Windsor Road on-ramp could commence. This is a permanent closure. Passengers who previously used this bus stop should make their way to the closest alternative bus stop, please see the map below.



Hills M2 Upgrade

A team consisting of The Roads and Traffic Authority of NSW, the Hills Motorway Limited and Hills Motorway Management Limited (as trustee of the Hills Motorway Trust)

Go to: www.hillsm2upgrade.com.au
Live traffic: www.livetrafficnsw.com.au/
Email: enquiries@hillsm2upgrade.com.au
Call: 1800 196 266 (select option 2)
Post: PO Box 379, North Ryde BC NSW 1670

July 2011

Below - The eastbound bus stop on Talavera Road, between Christie Road and Herring Road, Macquarie Park was temporarily relocated to Christie Road (near the corner of Talavera Road) on 22 June 2011. Please see map below.

This bus stop will be reinstated once the motorway upgrade has been completed.

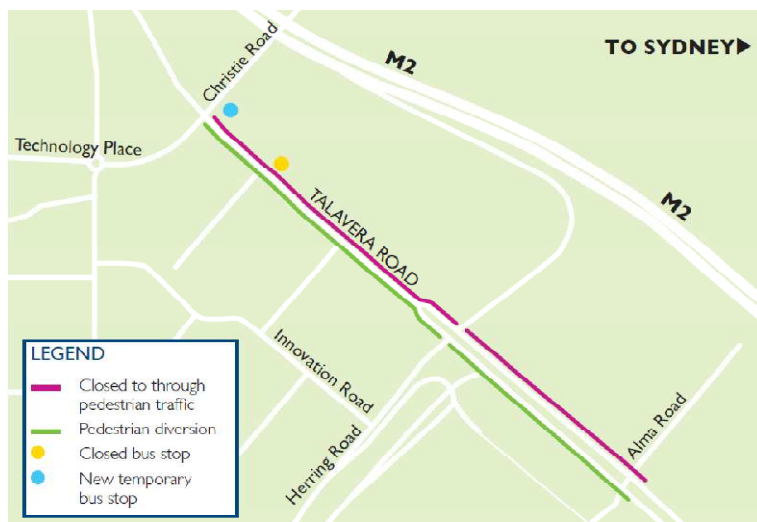

For further information regarding these bus services, contact 131 500 or the bus operators.

Q: What bus services are affected by the upgrade work?

A: The permanent closure of the Beecroft bus ramp in January 2011 has resulted in re-routing of Hillsbus 611 and Busways 740 services. Passengers should contact Hillsbus or Busways or visit their websites www.hillsbus.com.au or www.busways.com.au for more details on bus route and timetable changes.

Q: Why hasn't a 'tidal flow' bus lane been implemented as per the Environmental Assessment dated May 2010?

A: The Environmental Assessment sought approval to create a temporary tidal flow bus lane from Windsor Road to Pennant Hills Road and from Pennant Hills Road to a suitable merge point near Murray Farm Road Bridge.

February 2011

This proposal was re-examined in February 2011, prior to being implemented. It was concluded that the benefit of operating a 'tidal flow' bus lane was outweighed by the potential for greater traffic disruptions to occur as a result of a bus breakdown or accident within the 'tidal flow' bus lane.

This was due to the 'tidal flow' bus lane requiring concrete safety barriers on both sides to protect buses from oncoming traffic. The safety barriers would restrict access for breakdown or emergency vehicles and prevent following buses to pass. A decision was made to maintain an

Hills M2 Upgrade

A team consisting of The Roads and Traffic Authority of NSW, the Hills Motorway Limited and Hills Motorway Management Limited (as trustee of the Hills Motorway Trust)

Go to: www.hillsm2upgrade.com.au
Live traffic: www.livetrafficnsw.com.au/
Email: enquiries@hillsm2upgrade.com.au
Call: 1800 196 266 (select option 2)
Post: PO Box 379, North Ryde BC NSW 1670

eastbound only bus lane between Windsor Road and the Kent Street footbridge during construction. This arrangement required the removal of the westbound bus lane.

March 2011

The bus operations under the new configuration were further reviewed in March 2011 following an accident involving a westbound bus attempting to merge into a general traffic lane. In consultation with bus operators and transport agencies, a westbound bus lane between Barclay Road and Windsor Road was reinstated by removing the eastbound bus lane on this section of the motorway. Buses no longer need to merge into general traffic from the Barclay Road bus stop.

Current arrangement

- Westbound from the Barclay Road bus stop to Windsor Road.
- Eastbound from the Barclay Road bus stop to the Kent Street footbridge, Epping

The current bus lane arrangement has been agreed to by the bus operators, the Department of Planning and Infrastructure, the Department of Transport (formerly Transport NSW), the RTA, the Transport Management Centre and the Hills M2 motorway operator.

Bus operations and safety on the motorway during construction remain a priority for the motorway operator, the Hills M2 upgrade project team and the RTA. Bus operations and safety will continually be monitored and reviewed.

Q: Will there be further changes to the bus lane arrangements?

A: The management of traffic will be closely monitored throughout the construction period. It is likely that further changes may be required. Any changes will be undertaken in consultation with bus operators, other industry representatives and the RTA. Bus patrons will be notified of any changes before they occur.

Q: Why was the Beecroft bus ramp removed?

A: The motorway will be widened by an additional lane in each direction at this location. The permanent removal of the ramp allows for the widening and reduces impacts on Devlins Creek and nearby properties, including Epping Heights Public School.

The area is initially being used as a work zone and a compound site to lengthen the Beecroft Road Bridge. The bus ramp will be demolished later to allow the motorway to be widened in this area.

Q: What bus lane arrangements will be in place when the upgrade work is completed?

A: The westbound and eastbound bus lanes (approximately seven kilometers in each direction) will be reinstated between Windsor Road, Baulkham Hills and just west of the Kent Street, Epping footbridge after the upgrade is completed.

To provide an improved service for buses and vehicles carrying two or more people along the motorway, a new transit lane (T2) will be established from Terrys Creek, Epping to near Lane Cove Road, North Ryde.

Q: Will bus services using over bridges, such as Murray Farm Road Bridge, be affected?

A: Bus services will continue to use the bridges over the motorway during construction. However, there may be delays as over bridges, including Murray Farm Road Bridge, will operate under changed traffic conditions during construction. These changes include one-way traffic controlled by signals and reduced speed limits. The project team will continue to maintain regular discussions with bus operators and keep them informed of current traffic conditions that may affect their services.

Q: When will we find out more about what is happening?

A: The project team will keep the community informed via regular community updates, letterbox notifications and website updates as further information becomes available.

Q: How can I contact the project team?

A: The community complaint and information line 1800 196 266 (select option 2) is attended during the day and night during construction. Complaints received will be responded to within two hours and investigation of the complaint will proceed at the earliest opportunity. If you have any questions or would like to provide feedback please contact the project team on 1800 196 266 or email enquiries@hillsm2upgrade.com.au .