

28 December 2010

Our reference: app.bus stops. Ch: 5250 and Ch:5750

Traffic management - Night work notification: January 2011

Dear Resident,

The M2 Upgrade will widen the existing motorway between Windsor Road, Baulkham Hills and Lane Cove Road, North Ryde and will deliver four new ramps to improve access to the motorway. The project aims to provide efficient and integrated transport for the North-West Sydney community. Major work is expected to commence in early 2011 and will take approximately two years to complete.

The M2 Motorway is an important part of the overall Sydney road and transport network. This means that the motorway must still operate during construction. This requires some traffic management works to be completed outside of normal construction hours, as follows:

- A temporary crossover needs to be constructed on the motorway to allow motorists to travel in both directions on one carriageway. This will allow work to be carried out safely on the other carriageway. This work has been approved by the Department of the Environment Climate Change and Water (DECCW) to be carried out at night because it requires full lane closures. The use of crossovers and contraflow traffic will shorten the duration of night work required to install safety traffic barriers.

Weather permitting, this work will take place on the dates shown over the page. Hours of work are from 8 pm until 5.30 am. Machinery and equipment used will include lights, generator, saw cutting machine, excavator, tipper trucks, water tankers, road sweeper, roller, asphalt paving machine, core drill, and delivery trucks.

You may experience increased noise levels as a result of this work. The project team will take several measures to keep this to a minimum, including:

- using non-tonal reversing alarms;
- shrouding all stationery equipment; and
- completing saw-cutting before midnight, except if it is unsafe to leave the pavement in the state it is in at that time.

The information/complaints line 1800 196 266 will be attended during the day and night during construction. Complaints received via the 1800 number will be responded to within two hours and investigation of the complaint will proceed at the earliest opportunity.

If you have a question or would like to provide feedback please contact the project team on the project number 1800 196 266 or email enquiries@hillsm2upgrade.com.au

Kind regards

M2 Upgrade Community Relations Team

If you need an interpreter, please call the Translating and Interpreting Service (TIS National) on **131 450** and ask them to telephone the M2 Upgrade project information line on 1800 196 266. Our business hours are 8.30am to 5.00pm Monday to Friday.

M2 Upgrade project

A team consisting of The Roads and Traffic Authority of NSW, The Hills Motorway Limited and Hills Motorway Management Limited (as trustee of the Hills Motorway Trust)

Go to: www.hillsm2upgrade.com.au

Live traffic: <http://livetraffic.rta.nsw.gov.au/>

Email: enquiries@hillsm2upgrade.com.au

Call: 1800 196 266 (free call)

Post: Locked Bag 2215, North Ryde BC NSW 1670



M2 Upgrade



Cantonese

若你需要口譯員，請致電**131 450**聯絡翻譯和口譯服務署 (TIS National)，要求他們致電 1800 196 266 聯絡 M2 Upgrade project information line。我們的工作時間是 8.30am to 5.00pm Monday to Friday。

Mandarin

如果你需要口译员，请致电**131 450**联系翻译和口译服务署 (TIS National)，要求他们致电1800 196 266 联系 M2 Upgrade project information line。我们的工作时间是 8.30am to 5.00pm Monday to Friday。

Korean

통역사가 필요하시면 번역통역서비스 (TIS National)에 131 450으로 연락하여 이들에게 1800 196 266 번으로 M2 Upgrade project information line에 전화하도록 요청하십시오. 저희의 근무시간은 8.30am to 5.00pm Monday to Friday 입니다.

M2 Upgrade project

A team consisting of The Roads and Traffic Authority of NSW, The Hills Motorway Limited and Hills Motorway Management Limited (as trustee of the Hills Motorway Trust)

Go to: www.hillsm2upgrade.com.au

Live traffic: <http://livetraffic.rta.nsw.gov.au/>

Email: enquiries@hillsm2upgrade.com.au

Call: 1800 196 266 (free call)

Post: Locked Bag 2215, North Ryde BC NSW 1670



Dates of night work: January 2011

| Works Title | 17 | 18 | 19 | 20 | 21 | 22 | 23 | 24 | 25 | 26 | 27 | 28 | 29 | 30 | 31 | 1 | 2 | 3 |
|--|------|------|------|-------|----|----|----|----|----|----|------|------|----|----|-------|---|---|---|
| I. Temporary pavement at bus stop Chainage :5250 -5350 | Blue | Blue | Blue | Green | | | | | | | Blue | Blue | | | Green | | | |

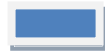

Dates of night work



Contingency (wet weather) dates

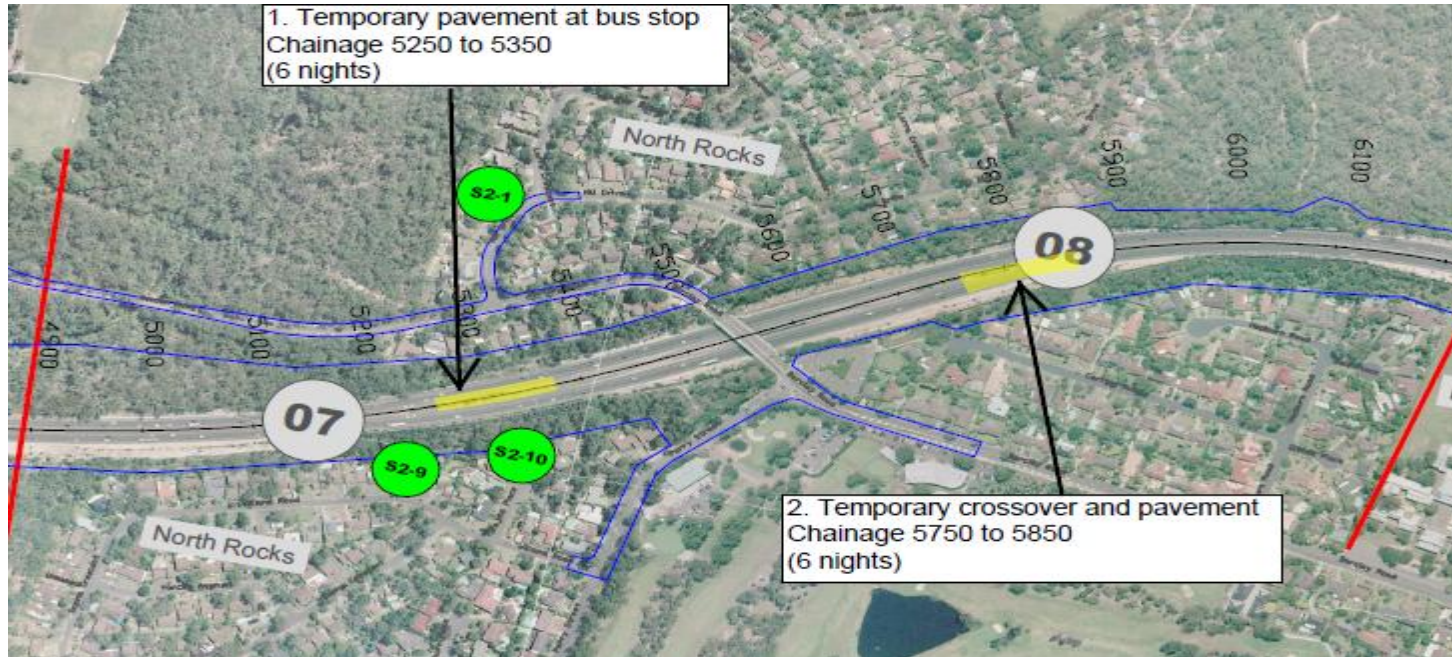

M2 Upgrade project

A team consisting of The Roads and Traffic Authority of NSW, The Hills Motorway Limited and Hills Motorway Management Limited (as trustee of the Hills Motorway Trust)

Go to: www.hillsm2upgrade.com.au

Live traffic: <http://livetraffic.rta.nsw.gov.au/>

Email: enquiries@hillsm2upgrade.com.au

Call: 1800 196 266 (free call)

Post: Locked Bag 2215, North Ryde BC NSW 1670

